

MAKING AN EASEL TRAY

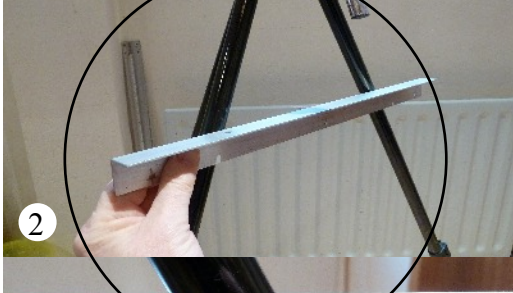

1



2



3



4



5



6



7

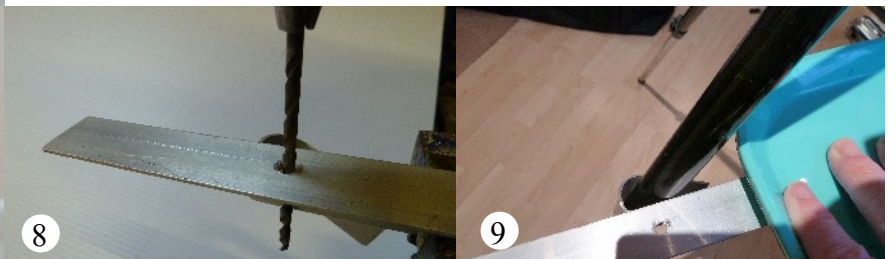

8

9

1. To hold my brushes, sponge, palette etc., I use a tray fitted to an aluminium frame that fits on to any easel. It is reasonably straightforward to make and you will need the following:
Length of Aluminium angle 1"x1" (25mm)
Plastic or metal tray
Small hacksaw
File
Drilling machine with a variety of bits

2. Decide on where you want the tray to fit. I would suggest that you leave sufficient space to hang your water container above it but don't have it so low that you need to stoop to reach it.. You will also need to make sure that your tray will fit between the legs of the easel. A space of at least 1/2 inch is needed on each side between the leg and the tray to allow it to be fitted and removed. Using the hacksaw, cut your aluminium angle to allow at least 3" extra at each side.

3. Mark a line on the aluminium at each side using the easel leg to guide you and using the hacksaw (4) cut from the end up to the line.

5. Bend the aluminium using the line as a guide. It is best to clamp the aluminium securely but the metal should bend easily by hand. Smooth the rough edges using the file

6. Return the aluminium to the easel and bend each side round the leg. Mark each bend in line with the easel leg

7. Cut at the line and smooth with the file. If the aluminium is not cut at this point it will be impossible to fit or remove it once the tray is fitted.

8. (Optional) Drill some holes in the extra aluminium at each side to hold your brushes. Start with a small hole and work up in size to suit each brush

9. Fit your choice of tray to the aluminium. I use a plastic picnic plate and stick it to the aluminium using strong double sided pads. I used pads that are used to stick car number (license) plates. Alternatively you could use a metal tray drilled and blind rivetted to the aluminium.